

### DALI-LINK - System devices

## PS-DALI-LINK-USB-REG



white , Part No. 93189

### Product Information

- DALI power supply with integrated USB interface for DIN-rail mounting
- For example, 45 DALI luminaires and 10 DALI-LINK control devices (multi-sensors or push-button interfaces) can be connected to the power supply.
- Integrated USB interface allows expansion to networkable B.E.G. LUXOMAT<sup>®</sup> net DALI-SYS lighting management solution
- Integrated LEDs for visualisation of operating information
- Commissioning of the B.E.G. LUXOMAT<sup>®</sup> net DALI-LINK solution takes place via a free app and the PBM-DALI-LINK-4W-BLE push-button module
- Suitable for: 93845, ...

### Technical Data

|                                      |   |
|--------------------------------------|---|
| <b>Voltage:</b>                      | 230 V AC -15/+10% 50 / 60 Hz                          |
| <b>Dimensions:</b>                   | (4 TE) 90 x 72 x 64 mm                                |
| <b>Settings:</b>                     | with Firmware update function button, B.E.G. PC Tools |
| <b>Output voltage:</b>               | 16 V DC   |
| <b>Power consumption:</b>            | 6 W   |
| <b>Degree / class of protection:</b> | IP20 / Class II                                       |
| <b>Ambient temperature:</b>          | +5 °C to +45 °C                                       |
| <b>Housing:</b>                      | Polyamide, UV-resistant                               |

**Connections and wires:** USB

**Nominal current (max.):** 210 mA

## Description

| Description          | Colour | Part number | EAN number    |
|----------------------|--------|-------------|---------------|
| PS-DALI-LINK-USB-REG | white  | 93189       | 4007529931897 |

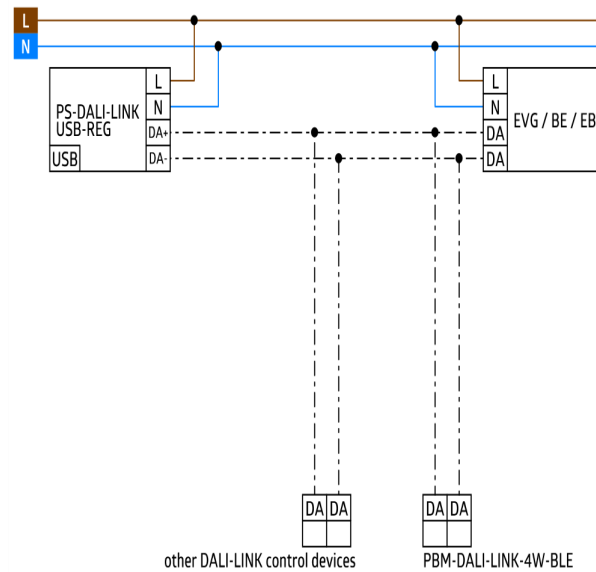
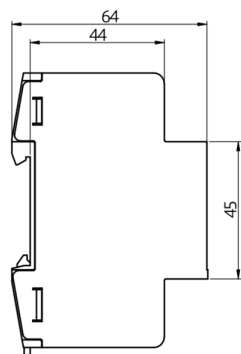
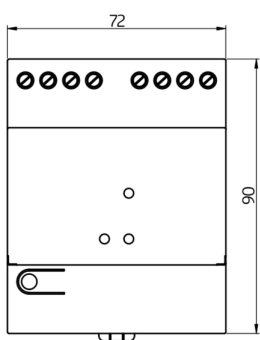

Dimensions 93189

Wiring diagrams